



POSITIVE POSTURE®

**TRUE ZERO GRAVITY™ RECLINER**  
ASSEMBLY INSTRUCTIONS & OWNER'S MANUAL

---

## Contents

Thank You.....	2
Safety Precautions.....	3
Assembly.....	6
Operating .....	10
Care & Cleaning.....	13

## Thank You

Congratulations on owning your new Positive Posture® True Zero Gravity® recliner. You just purchased the most comfortable seat in your house. We know you'll quickly realize that your True Zero Gravity recliner is a beautifully balanced blend of aesthetics and comfort technology. From concept to design to production, we aim to develop, test, and build The Most Comfortable Furniture on Earth™.

We're confident that your chair will provide you with many years of relaxation.

Your new Positive Posture chair includes a 3-year in-home warranty. If you have any questions or issues during or after the warranty period, PLEASE CONTACT POSITIVE POSTURE DIRECTLY by dialing 720-616-5000 or sending an email to [service@positiveposture.com](mailto:service@positiveposture.com).

We don't want you to overlook any of your chair's features, and we want you to use it safely, so before using your chair please read and understand the entire Owner's Manual, especially the important Safety Precautions section of this booklet.

Thank you again for making Positive Posture a part of your daily life.



## Safety Precautions

The following safety tips, warnings, and precautions should always be followed when using your recliner.

### PLEASE SAVE THESE INSTRUCTIONS.

- The user weight limit for this recliner is 285 lbs./130 kgs. No one weighing more than 285 lbs./130 kgs. should use this device. Use of this recliner by anyone over 285 lbs./130 kgs. immediately voids any warranties and involves serious risks that may result in injury.
- If you experience any abnormal sensations during the operation of this product, turn off the power immediately and do not use the product. Consult your physician.
- Do not place any body parts near the footrest mechanism or the underside of the chair while your recliner is in use.
- Touching the mechanism can result in injury.
- Do not use any electric supply other than 120V A/C. There is a risk of shock or fire with the use of improper power.
- This product is electric and has an inherent risk of shock. Inspect the power cord regularly for damage. Immediately unplug and do not use your recliner if you notice any damage to the power cord.
- Unplug when not in use and before installing or removing any parts.
- Periodically check and re-tighten seat back mounting bolts.
- Use this product only for its intended use as described in this manual. Do not use attachments not recommended by the manufacturer.
- Never operate this product if it is not working properly, if it has been dropped or damaged, or if the chair is exposed to excessive moisture. Contact a service center for examination and repair.
- Do not carry, lift, or pull this appliance by supply cord or use cord as a handle.
- Keep the power cord away from heated surfaces.
- Never drop or insert any object into any opening.

## Safety Precautions continued...

- Do not use outdoors.
- Do not operate where aerosol (spray) products are being used or where oxygen is being administered.
- Do not use this product when standing on a damp floor, or when any part of the body is in contact with plumbing or any similar electrical ground.
- Stop using your recliner if you hear unusual sounds or noises.
- Do not stand on or in your recliner. Use only while seated. Never place excessive weight on the footrest when it is extended. Do not lift from the footrest as damage will result.
- This recliner is not intended for use by anyone with reduced physical, sensory, or mental capabilities, or lack of experience and knowledge, unless they have been given supervision or instruction concerning use of the recliner by a person responsible for their safety.
- Never attempt to repair this product yourself.
- To reduce the risk of electric shock, your recliner has a polarized plug. The plug will fit in a polarized outlet only one way. If the plug does not fit fully in the outlet, reverse the plug. If it still does not fit, contact a qualified electrician to install the proper outlet. Do not alter the plug on your recliner in any way.
- This product is designed for personal in-home use. Commercial use voids the manufacturer's warranty.
- Keep children away from all moving parts.
- Always use caution when using this product and ensure children and pets as well as any other objects are clear of your recliner (front and back) before reclining, inclining, or using the footrest.
- Children should never play with or on the recliner.
- Close supervision is necessary when this product is used by, on, or near children or disabled persons.

# ASSEMBLY INSTRUCTIONS



POSITIVE POSTURE®

After you unpack the box(es), expect assembly to take approximately 10 minutes. You can also find assembly videos at [positiveposture.com/assembly](http://positiveposture.com/assembly).

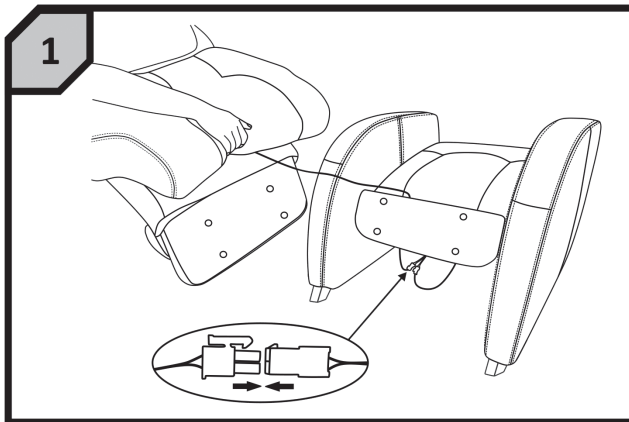
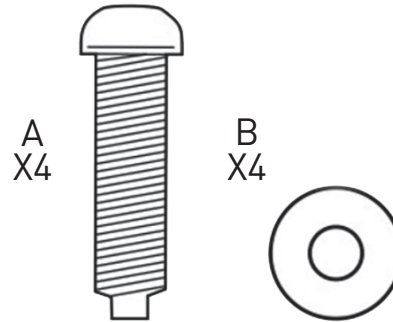

*This step only applies to Café and Lift Assist recliners.*  
Thread plug from backrest heat pad through the back of the seat and connect with the heat pad plug in the seat base.

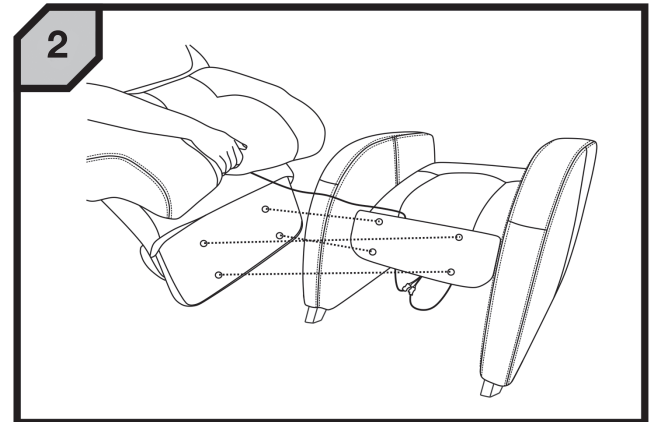

Lift and hold back in place so bolt holes align. During this step, be careful not to pull heat line taught.

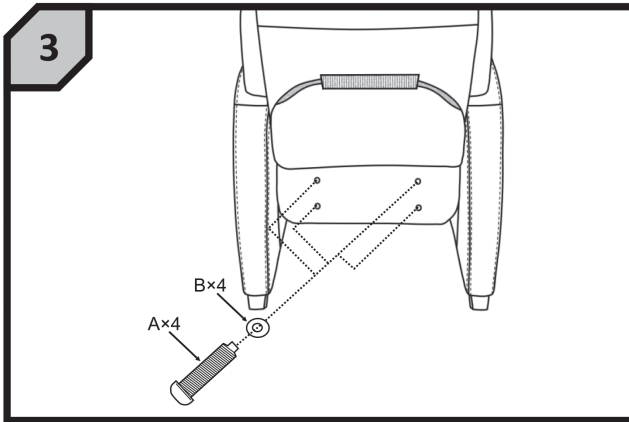

Insert and tighten all bolts as shown. Use allen wrench to fully tighten.

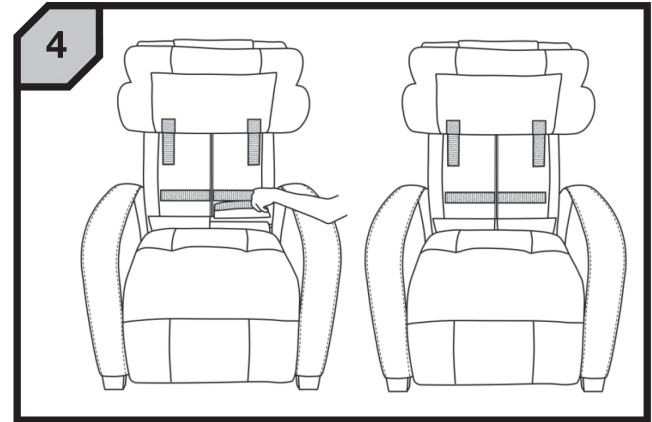

Lift back cushion and tuck flaps with velcro between back and base. Pull tightly before adhering.

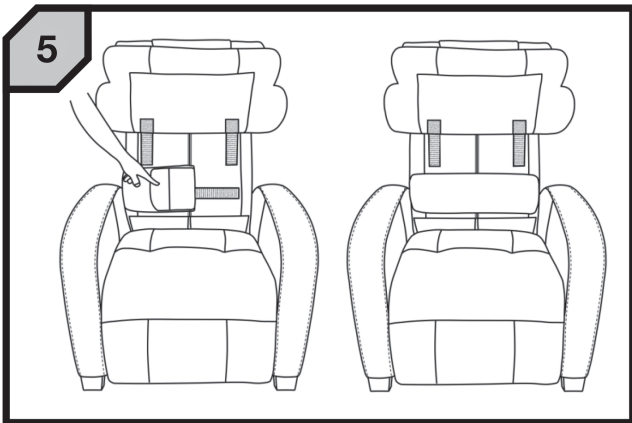

Lift back cushion and adjust lumbar cushion to your desired position. If stronger lumbar support is preferred, a Premium Upgrade can be purchased at [positiveposture.com](http://positiveposture.com).

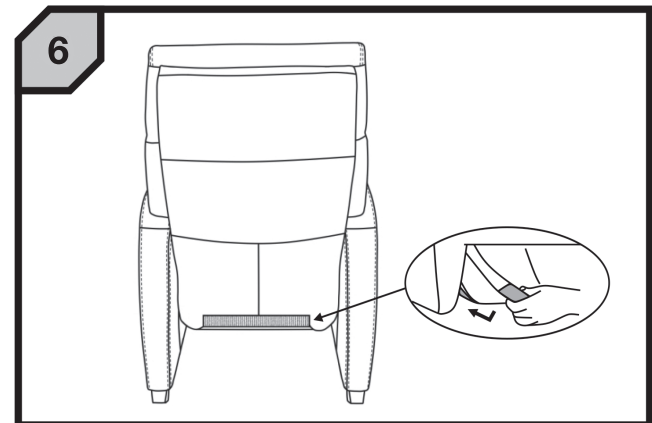

Pull seatback upholstery so it wraps around the frame.



## CAFÉ AND LIFT ASSIST RECLINERS:

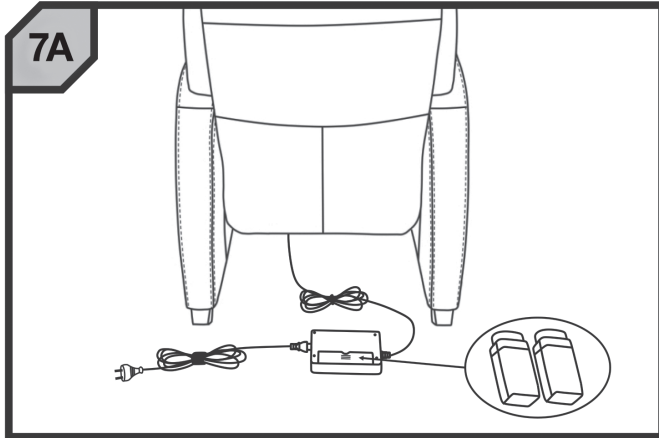

Insert two 9V batteries into compartment shown for backup power.

## ALL OTHER CHAIRS:

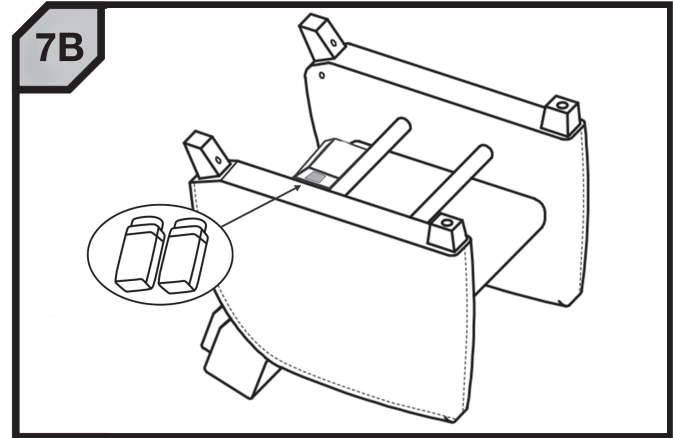

Tilt chair upside down and locate battery backup door on side of control box (it has a silver label on it). Remove the door and install two 9V batteries.

# OWNER'S MANUAL



POSITIVE POSTURE®

## Operating

### Adjusting the Recline & Legrest

**For your safety, before adjusting the recline angle be sure there is nothing located directly behind or beneath the chair.**

For maximum seating comfort and full-body support, slide your buttocks all the way back in the chair and lean against the backrest before reclining.

Use the switches on each armrest to control the angle of the back and legrest. When sitting, the switch on the right controls the recline, while the switch on the left controls the legrest. It's easy to remember as:

R = Right = Recline    L = Left = Legrest

The back recline and legrest adjustments on your True Zero Gravity recliner operate independently from each other, allowing you to infinitely customize the seating angles.

To activate the recline or legrest, gently depress the front or back button on the switches. Note that the recline and legrest movements may be operated at the same time. Release the button(s) when you reach the desired angle. The chair back and legrest will automatically stop when you reach the maximum recline/extension or the full upright position.

*Note: Some True Zero Gravity models are outfitted or accessorized with a remote control. This may also be used to adjust the angle of the back and legrest. Remote operation instructions are included in the box separately.*

## Operating continued...

### **Adjusting the Headrest Support Angle**

While seated, reach up with both hands and grasp both sides of the headrest around the frame—be sure you reach high enough to reach beyond the padded back. You should feel the rigid frame beneath the upholstery. Grasp the frame and tilt the headrest forward (or push it back) until you Find Your Comfort. The headrest will remain fixed in a position until you adjust it again.

### **Adjusting the Cervical Neck Support**

All True Zero Gravity chairs come with a cervical neck pillow. This drapes over the top of the backrest. When sitting in the chair, adjust this pillow up or down to Find Your Comfort.

### **Adjusting the Lumbar Support**

All True Zero Gravity chairs are designed to accept an accessory lumbar support. Where the backrest upholstery meets the seat, you'll notice that you can lift the back pad up off the backrest. When you do this you will see an accessory lumbar support which can be adjusted to sit higher or lower to support the small of your back. Simply pull it off the velcro strips and attach in your desired location.

## Operating continued...

### Additional Features & Functions

Your True Zero Gravity chair comes with some great features not found in any other chair.

#### Extra Long Power Cord

For your convince your recliner comes with an extra long power cord avoiding the need for placing the chair close to an outlet or using extension cords.

#### Cord Manager

If you don't need all of the cord length provided, simply use the cord manager strap to secure any excess cord length and place the bundled portion of the cord on the floor underneath the chair.

#### Battery Backup

In the event of a power failure, this system will allow you to operate your chair for a short while. Be sure to install the batteries required (see assembly instructions for details; sold separately). *Note: Battery replacement is recommended annually and after use of the battery back up system.*

#### Adjustable Feet for Uneven Floors

To ensure your chair is level and stable, each foot on your chair is adjustable. Turn each foot counter-clockwise to extend it and clockwise to shorten it. *Note: Not all True Zero Gravity chairs are equipped with this feature (ex. Café, Sora).*

#### Additional Accessories (Sold Separately)

Your True Zero Gravity chair has been built with the option to add additional accessories for increased comfort, care, and convince. Visit [positiveposture.com](http://positiveposture.com) or your nearest retailer to learn more about these options.

## Care & Cleaning

### General Care Tips

*Note: For your safety, please unplug your chair before commencing any care or cleaning.*

- Avoid direct, prolonged exposure to sunlight. Intense and prolonged exposure may result in deterioration and discoloration of upholstery.
- Keep away from sources of heat such as radiators and fireplaces (a distance of at least 12" is required). Intense and prolonged exposure may result in deterioration of upholstery and foams.

### Fabric Care

- Vacuum often to remove dirt and surface oils. Always use a soft bristled brush to avoid snagging or pulling of fabric.
- Promptly treat spots and stains using a soft absorbent cloth, blotting the stain rather than rubbing.
- For tough stains dampen a cloth with warm water and rub gently with a neutral soap. Rinse thoroughly. Once dry, brush the fabric with a soft brush. *\*\*Pre-test, in an inconspicuous place on your recliner, any cleaning solution you choose to use for color loss and compatibility.*
- Never use harsh cleaners or chemicals as they may damage the finish.
- Keep pets off furniture. Pet body oils are difficult to remove and can have an impact on the appearance and longevity of your chair's upholstery.
- Do not leave newspapers on any upholstered furniture.

## Care & Cleaning continued...

### Leather Care

- Vacuum and dust often with a soft clean cloth.
- Promptly treat spots and stains using a soft absorbent cloth, blotting the stain rather than rubbing.
- Contact a professional leather cleaning service for more difficult stains.
- Never use harsh cleaners, chemicals, or saddle soap, as they may damage the finish. *\*\*Pre-test, in an inconspicuous place on your recliner, any cleaning solution you choose to use for color loss and compatibility.*
- Keep pets off furniture. Pet body oils are difficult to remove and can have an impact on the appearance and longevity of your chair's upholstery.
- Do not leave newspapers on any upholstered furniture.

*Note: All leather has natural markings which distinguish genuine leather from man-made materials. These markings may be present on your furniture and is your assurance that you have a true leather. Each area of hide will absorb dye in varying amounts, and may be darker or lighter than other areas. Variations on leather furniture are natural, and in no way affect the strength of the leather.*

Over time, changes in color and signs of wear are natural and normal. Irregularities in the consistency and depth of the color and texture should not be considered a fault but inherent of the natural beauty of the leather. Indeed, many appreciate the unique ability of leather to take on “character over time”.



POSITIVE POSTURE®

**TO REGISTER YOUR WARRANTY, PLEASE VISIT  
[POSITIVEPOSTURE.COM/WARRANTY](https://www.positiveposture.com/warranty)**

©2017 Positive Posture

Positive Posture and Find Your Comfort are trademarks of Positive Posture LLC